





Proposed limit of development area based on topography and potential to impact landscape values

Existing restrictive covenant

Ridge line, keep development from top and edge.

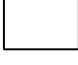
No change proposed due to topography and potential impact on landscape values

**LEGEND**

-  Lot Boundaries
-  2m Contours
-  Existing Covenant
-  Proposed Modified Covenant

**DISCLAIMER**  
 Craig Pursey Planning Pty/Ltd does not warrant the accuracy in this publication and any person using or relying upon such information does so on the basis that Craig Pursey Planning Pty Ltd shall bear no responsibility or liability whatsoever for any errors, faults, defects or omissions in the information



SCALE  
1 : 4500

SHEET  
1 of 2

DATE  
08/07/2023

**PROPOSED MODIFIED RESTRICTIVE COVENANT.**  
 Lots 151 to 157 Point Henry Road, Bremer Bay

9.3.4 b) Plan Showing Modified Restrictive Covenant Location

INSTRUMENT	DESCRIPTION
NAME OF INSTRUMENT	ALL DOC
NAME OF INSTRUMENT	EMERGENCY ACCESS
DATE OF INSTRUMENT	
NAME OF INSTRUMENT	

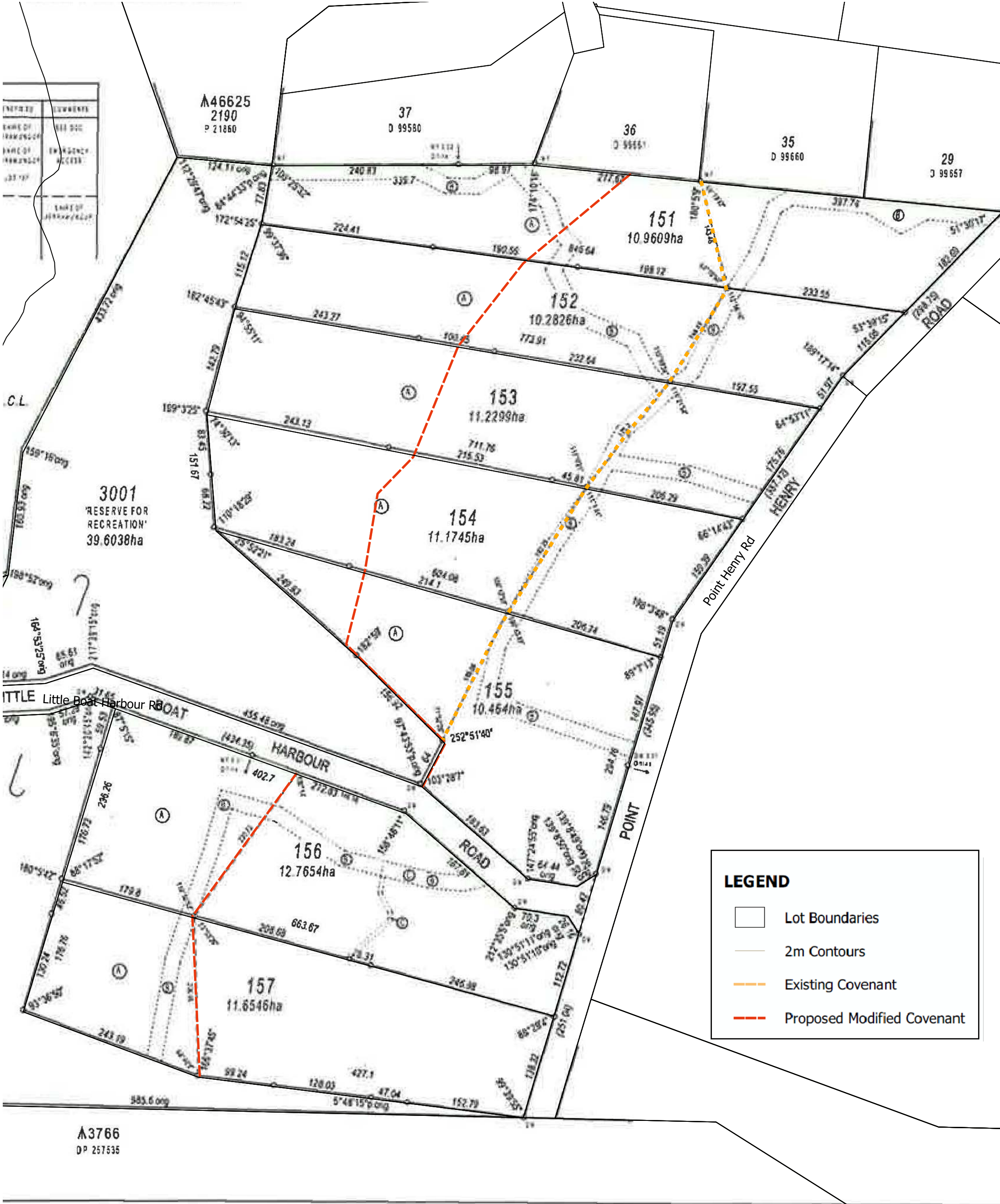

**LEGEND**

- Lot Boundaries
- 2m Contours
- Existing Covenant
- Proposed Modified Covenant

**DISCLAIMER**

Craig Pursey Planning Pty/Ltd does not warrant the accuracy in this publication and any person using or relying upon such information does so on the basis that Craig Pursey Planning Pty Ltd shall bear no responsibility or liability whatsoever for any errors, faults, defects or omissions in the information

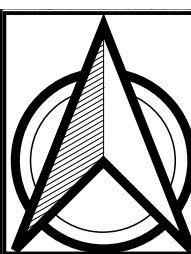

SCALE  
1 : 4500

SHEET  
2 of 2

DATE  
11/07/2023

**PROPOSED MODIFIED RESTRICTIVE COVENANT.**  
Lots 151 to 157 Point Henry Road, Bremer Bay